

**2018 SAONA 47 3C,3H “Quite the Catch” Jamestown RI**  
\$1400/day + Incidentals

GENERATOR

AC

FULLY BATTENED MAIN w/LAZY JACKS

Hydraulic lift DINGHY DAVITS

ELECTRONIC FLUSH HEADS

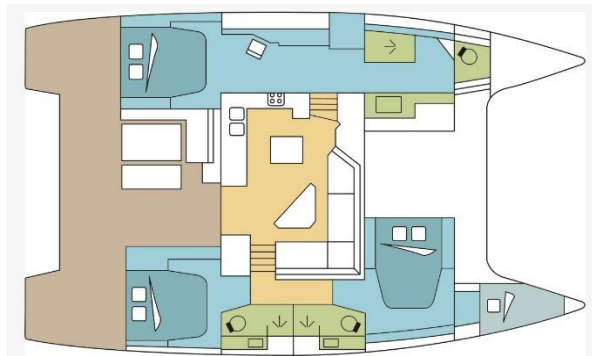

[Click on any pictures to see more](#)

Saona 47 O.V. with A/C  
**Boat model:**

Catamaran  
**Boat type:**  
 2018  
**Millesime year:**  
**Base on first charter date:**  
 05/10/2019  
**Super Premier until:**  
 05/10/2021  
**Premier until:**  
 05/10/2024  
**Confort until:**  
 05/10/2024  
**Economy from:**  
 46 ft | 13,94 m  
**Length:**  
 9  
**Number of persons:**  
 3  
**Number of double cabins:**  
 1  
**Number of single cabins:**  
 3  
**Number of showers:**  
 3  
**Number of heads:**  
 0  
**Double bunk:**  
 2  
**Salon:**  
 1  
**Front peak:**  
 3  
**Double berth:**

**Amenities**

Air conditioning	yes, 60 HZ 110 V
Generator	yes, 12 KW , 110V
Freezer	yes, 90L / 12V

**Specifications**

LOA	13.94 m / 42.65 ft
Beam	7.70 m/22.96 ft
Draft	1.30 m /3.28 ft
Water Tank	700 l / 184.92 US GAL
Fuel Tank	2 x 470 l / 2 x 124 US GAL
Engine	2 x 60 CV VOLVO

**Accomodation**

Double bed	3
Convertible saloon table double	
	3

Showers 3

Toilets yes, 1 - accessible via hatch or fwd cabin

Forepeak Cabin Single yes, in forepeak cabin

Skippers Toilet

**Passengers**

Recommended 6

Maximum 9

**Sails**

Main Sail Full - Battened 

Roller Genoa 

Lazy Jacks with Lazy Bag 

**Deck**

Fridge yes, in cockpit

Underwater Lighting yes, 2 x 21W 

Bimini Top yes, cockpit, lounge deck + foredeck

Cockpit cushions 

Cockpit speakers 

Cockpit table 

Cockpit Shower 

Electric Anchor Windlass 

Electric Winch yes, 2 

Self-tailing winches 

Dinghy 

Davits for the dinghy yes, hydraulic lift

Outboard Engine 

Swimming ladder 

**Navigation**

yes, Garmin

GPS Plotter		yes, Garmin
Autopilot		yes, Garmin
Wind Instruments		yes, Garmin
Speed Log		yes, Garmin
Depth Sounder		yes, Garmin
VHF		yes, Garmin
Radar		yes, Garmin
	<b>Facilities</b>	
Hot Water		yes, 110V
Cabin Fans		yes and in saloon
Radio		yes, fusion with bluetooth
TV		yes, 1 in salon and 1 in main cabin
Electric Toilet Pump		yes, 3
	<b>Galley</b>	
Refrigerator		yes, 190 L
Microwave		
	<b>Electric</b>	
Inverter		yes, 2000W / 110V
12 V Socket		yes, interior + exterior
Solar Panel		yes, 4 x 90 / 100 W